

<<21>>

Land Registry
Index map plan

Ordnance Survey map reference ST5576NE
Scale 1:2500
Plan prepared on 18/11/2010 at 00:00:01



© Crown Copyright. Produced by Land Registry. Reproduction in whole or in part is prohibited without the prior written permission of Ordnance Survey. Licence Number 100026316.

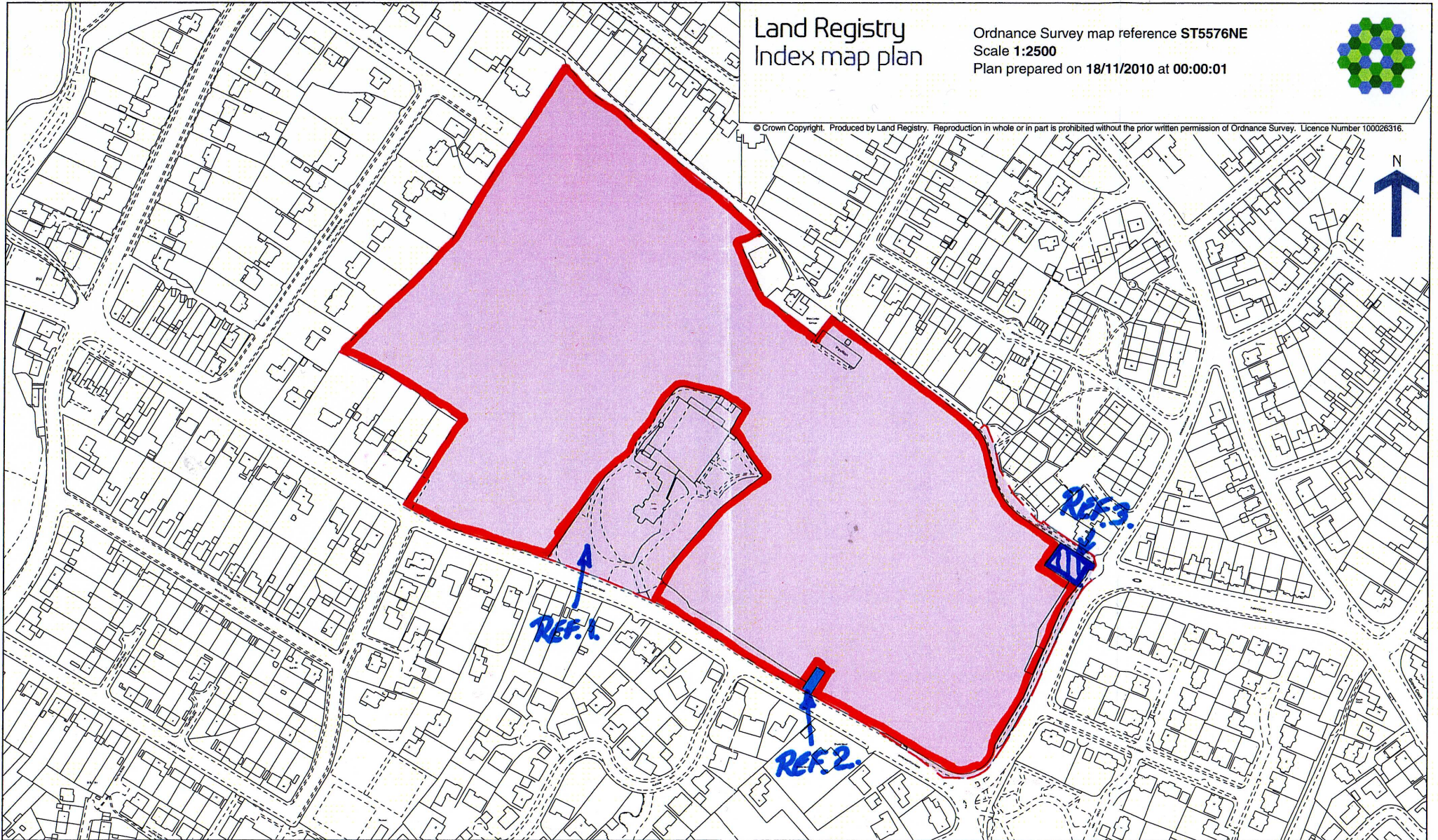

This plan should be read in conjunction with result E12MSJB.

This plan shows the general position, not the exact line, of the boundaries. It may be subject to distortions in scale. Measurements scaled from this plan may not match measurements between the same points on the ground. See Land Registry Public Guide 19 - Title Plans and Boundaries.

SEE NOTES
OF EXPLANATION.

PLAN. THREE



0640007002

THIS IS THE EXHIBIT
MARKED "PLAN THREE"
REFERRED TO IN THE
STATUTORY DECLARATION
OF DAVID NORMAN MAYER
MADE THIS 14th March 2011
BEFORE ME

DEVEREUX & Co.
52A HIGH STREET
WESTBURY-ON-TRYM

BRISTOL BS9 3DZ

TEL: 0117 959 3374/FAX 3355

DX 30354 WESTBURY-ON-TRYM

Angela
Solicitor